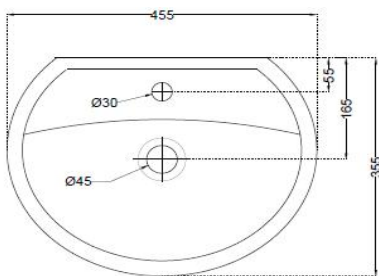

SPECIFICATION DATA SHEET
PRODUCT DETAILS

Manufacturer :	ESSCO	Type:	Wall Hung Basin
Range	Essco	Colour:	White
Outlet	Horizontal	Material:	Ceramic - Vitreous China
Technical Details:	Diameter of the tap hole 30 \varnothing +2 -1 mm,	BOM doc.NO.	ESW/02/2018/037
	ID of waste outlet hole 45 \varnothing +2 -1 mm Horizontal distance between the centre line of the tap hole and the centre line of the waste outlet hole \leq 110 mm		

ARTICLE NAME: WALL HUNG BASIN

TECHNICAL DIMENSIONS

TOP VIEW

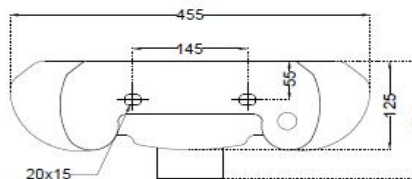

BACK VIEW

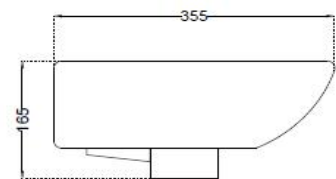

SIDE VIEW

 ALL DIMENSIONS ARE IN MM.
 (TOLERANCE \pm 5 MM)

PRODUCT DIMENSIONS

Length (mm)	Width (mm)	Height (mm)	Net weight (kg)
455	355	165	7.5

USP

Basin with Tap Hole, Packed with Overflow Hole Cap and Fixing Accessories

ACCESSORIES PROVIDED

Basin fixing screw	ZPS-MST-RB03
OVERFLOW CAP	ZPS-WHT-9012

CARE AND CLEANING GUIDELINES

- ★ Vitreous china sanitary ware products are fragile in nature and need to be handled with care (to avoid personal injury) at all times during its storage, handling, installation and use thereafter.
- ★ The product is heavy and it is recommended that two persons hold it while it is being fixed.
- ★ Carefully inspect the new product for damage before installation.
- ★ Risk of product damage. Over tightening may cause breakage or chipping of vitreous china.
- ★ Risk of external leakage. Do not lift or rock the bowl after placement.
- ★ Always test your cleaning solution on an inconspicuous area on the product before applying it to the entire surface.
- ★ Do not allow cleaners to sit or soak on the product.
- ★ Use a soft, dampened sponge or cloth to clean. Never use abrasive material like a bristle brush or scouring pad.
- ★ Wipe surfaces clean and rinse completely with water immediately after applying cleaners.
- ★ Clean Chrome, stainless steel surfaces once a week. Do not use cleaners containing chloride on chrome, stainless steel. If used, rinse the surface immediately to prevent corrosion.
- ★ Wherever chrome plating is used on the products, use only warm water to clean and then dry with a soft cloth.

CERTIFICATION

 Compliance : IS 2556.4:2004, IS 2556.1:1994, BS EN 14688 :2015/CE
 All technical dimensions are in accordance to British standards, Bureau of Indian Standards

PACKAGING DETAIL

Length (mm)	Width (mm)	Height (mm)	Gross Weight(kg)
460	350	165	8.00

LOADING PALLET DETAIL

Length (mm)	Width (mm)	Height (mm)	no of pieces on pallet
1140	1140	2285	52



Prepared By Designer Date	Controlled By Quality control	Verified By Product Manager	Approved By Sanitaryware Head
Revision/Version	1	Plotter Updated on	Month
			09-Jul Year 2018