

**SPECIFICATION DATA SHEET**

**PRODUCT DETAILS**

<b>Manufacturer :</b>	ESSCO	<b>Type:</b>	Orissa Pan WC
<b>Colour:</b>	White	<b>Flush valves</b>	Regular, Dual & I Flush advantages
<b>Outlet</b>	Vertical	<b>Material:</b>	Ceramic - Vitreous China
<b>Technical Details:</b>	Internal diameter of inlet hole dia. $\varnothing 50 \pm 3$ mm		
	External diameter of outlet hole dia. $\varnothing 100 \pm 5$ mm		
	Vertical distance between the Bowl bottom edge and the centre line of the inlet hole $\leq 215$ mm		

**PRODUCT IMAGE**



**TECHNICAL DRAWING**

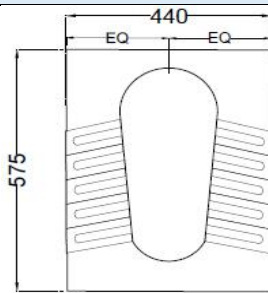

TOP VIEW

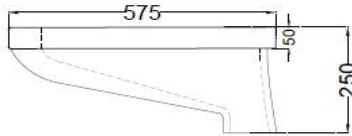

SIDE VIEW

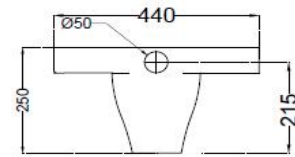

BACK VIEW

<b>Product Dimension</b>	440x575x250 mm	<b>FEATURES</b>
<b>Product Weight</b>	15.4 kg	Orissa Pan, Anti germ glaze.

**ACCESSORIES EXCLUDED**

Cistern

WHE-WHT-183L

**CERTIFICATION**

Compliance : IS 2556.2:2004/IS 2556.1:1994 EN 997 :2012+A1



All technical dimensions are in accordance to British standards, Bureau of Indian Standards

DISCLAIMER: Our every effort has been made to ensure factual accuracy, the information presented subject to changes due to requirements in different sites, markets and/ or countries. All dimensions are in mm (Tolerance  $\pm 5$  MM). Jaquar reserves the right to make the necessary amendments at any time without prior notice.